

10N(Pipe接口, 两通) Pipe Connection, 2-Way

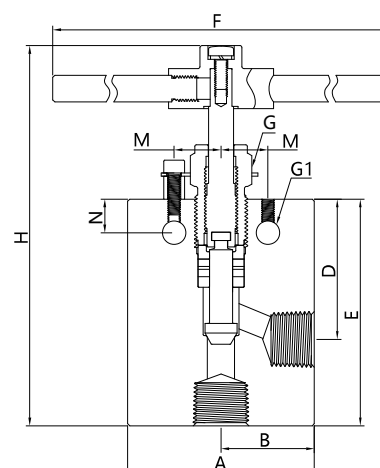

角型/Angle															
订购号 Ordering Number	接口类型 Connection	内通径 in. (mm)	尺寸 in. (mm)												
			A	B	C	D	D1	E	F	G	G1	H	M	N	阀体厚度
10NSS-FNS12-2	3/4 NPT	0.437 (11.10)	3.50 (88.9)	1.75 (44.5)		2.63 (66.8)		4.25 (107.9)	10.25 (260.4)	1.19 (30.2)	0.44 (11.2)	7.92 (201.3)	0.88 (22.4)	0.63 (16.0)	1.75 (44.5)
10NSS-FRT12-2	3/4 ISO														
10NSS-FNS16-2	1 NPT	0.562 (14.27)	4.12 (104.6)	2.06 (52.3)		3.31 (84.1)		5.12 (130.1)	10.25 (260.4)	1.64 (41.2)	0.56 (14.2)	9.94 (252.5)	1.25 (31.8)	1.13 (28.7)	1.75 (44.5)
10NSS-FRT16-2	1 ISO														