

SEALING RING

密封垫环(RX型钢垫圈)

Sealing ring (Type RX ring gaskets)

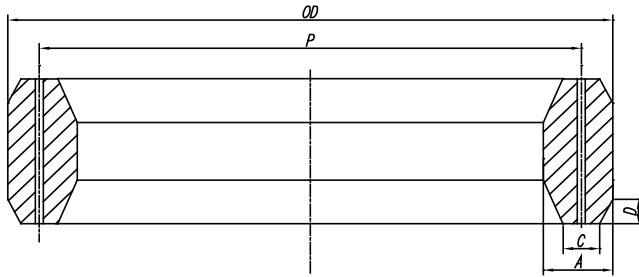

八角形 RX型 RX

示意图



实体图

RX型钢垫圈/Type RX ring gaskets

可选材质

- AISI4130, 410, SS316, SS304
- 不锈钢C271
- 其他特殊合金

注意

- RX型钢垫圈仅RX82~RX91在环截面上有压力通孔,
- 孔中心线位于尺寸C的中点,
- RX82~85的孔径为1.52mm;
- RX86~RX87的孔径为2.28mm;
- RX88~RX91的孔径为3.05mm;
- b. 这些尺寸的公差是 -0.38
- c. 这些尺寸的公差是 $+0.5$
- d. 只要垫圈宽度或高度的变化不超过0.20mm,
- 整个圆角上A加上公差0.1mm,
- 对宽度A和高度H是允许的。

特点

- 耐高温, 耐高压, 适用于高压法兰;
- 密封持久可靠;
- 适应压力, 温度有波动的工况条件;

Available materials:

- AISI4130, 410, SS316, SS304
- Stainless steel C271
- Other special alloys

NOTE:

- Only Rx82~Rx91 of RX type washers have pressure holes on the ring section.
- The center line of the hole is located at the midpoint of dimension C.
- The hole diameter of Rx82~85 is 1.52mm.
- The hole diameter of RX86~RX87 is 2.28mm,
- The hole diameter of RX88~RX91 is 3.05mm
- b. The tolerance of these dimensions is -0.38
- c. The tolerance of these dimensions is $+0.5$
- d. As long as the variation of the width or height of the gasket
- does not exceed 0.20mm, A plus a tolerance of 0.1mm on the entire fillet,
- width A and height H are allowed..

Characteristics :

- high temperature resistant, resistant to high pressure, suitable for high pressure flange;
- reliable sealing persistent;
- to adapt to the working conditions of pressure and temperature fluctuations;

code	P	OD	A	C	D	H	R1	E	F	R2	S
RX20	68.26	76.20	8.74	4.62	3.18	19.05	1.5	6.4	8.74	0.8	9.7
RX23	82.55	93.27	11.91	6.45	4.24	25.40	1.5	7.9	11.91	0.8	11.9
RX24	95.25	105.97	11.91	6.45	4.24	25.40	1.5	7.9	11.91	0.8	11.9
RX25	101.60	109.55	8.74	4.62	3.18	25.40	1.5	6.4	8.74	0.8	—
RX26	101.60	111.91	11.91	6.45	4.24	25.40	1.5	7.9	11.91	0.8	11.9
RX27	107.96	118.26	11.91	6.45	4.24	25.40	1.5	7.9	11.91	0.8	11.9
RX31	123.83	134.54	11.91	6.45	4.24	25.40	1.5	7.9	11.91	0.8	11.9
RX35	136.53	147.24	11.91	6.45	4.24	25.40	1.5	7.9	11.91	0.8	11.9
RX37	149.23	159.94	11.91	6.45	4.24	25.40	1.5	7.9	11.91	0.8	11.9
RX39	161.93	172.64	11.91	6.45	4.24	25.40	1.5	7.9	11.91	0.8	11.9
RX41	180.98	191.69	11.91	6.45	4.24	25.40	1.5	7.9	11.91	0.8	11.9
RX44	193.68	204.39	11.91	6.45	4.24	25.40	1.5	7.9	11.91	0.8	11.9
RX45	211.15	221.84	11.91	6.45	4.24	25.40	1.5	7.9	11.91	0.8	11.9
RX46	211.15	222.25	13.49	6.68	4.78	28.58	1.5	9.7	13.49	1.5	11.9
RX47	228.60	245.26	19.84	10.34	6.88	41.28	2.3	12.7	19.84	1.5	23.1
RX49	269.88	280.59	11.91	6.45	4.24	25.40	1.5	7.9	11.91	0.8	11.9
RX50	269.88	283.36	16.66	8.51	5.28	31.75	1.5	11.2	16.66	1.5	11.9
RX53	323.85	334.57	11.91	6.45	4.24	25.40	1.5	7.9	11.91	0.8	11.9
RX54	323.85	337.34	16.66	8.51	5.28	31.70	1.5	11.2	16.66	1.5	11.9
RX57	381.00	391.72	11.91	6.45	4.24	25.40	1.5	7.9	11.91	0.8	11.9
RX63	419.10	441.73	27	14.78	8.46	50.80	2.3	16.0	27.00	2.3	21.3
RX65	469.90	480.62	11.91	6.45	4.24	25.40	1.5	7.9	11.91	0.8	11.9
RX66	469.90	483.39	16.66	8.51	5.28	31.75	1.5	11.2	16.66	1.5	11.9
RX69	533.40	544.12	11.91	6.45	4.24	25.40	1.5	7.9	11.91	0.8	11.9
RX70	533.40	550.06	19.84	10.34	6.88	41.28	2.3	12.7	19.84	1.5	18.3
RX73	584.20	596.11	13.49	6.68	5.28	31.75	1.5	9.7	13.49	1.5	15.0
RX74	584.20	600.86	19.84	10.34	6.88	41.28	2.3	12.7	19.84	1.5	18.3
RX82	57.15	67.87	11.91	6.45	4.24	25.40	1.5	7.9	11.91	0.8	11.9
RX84	63.50	74.22	11.91	6.45	4.24	25.40	1.5	7.9	11.91	0.8	11.9
RX85	79.38	90.09	13.49	6.68	4.24	25.40	1.5	9.7	13.49	1.5	9.7
RX86	90.50	103.58	15.09	8.51	4.78	28.58	1.5	11.2	16.66	1.5	9.7
RX87	100.03	113.11	15.09	8.51	4.78	28.58	1.5	11.2	16.66	1.5	9.7
RX88	123.83	139.29	17.48	10.34	5.28	31.75	1.5	12.7	19.84	1.5	9.7
RX89	114.30	129.77	18.26	10.34	5.28	31.75	1.5	14.2	19.84	1.5	9.7
RX90	155.58	174.63	19.84	12.17	7.42	44.45	2.3	17.5	23.02	1.5	18.3
RX91	260.35	286.94	30.18	19.81	7.54	45.24	2.3	7.9	33.24	2.3	19.1
RX99	234.95	245.67	11.91	6.45	4.24	25.40	1.5	4.1	11.91	0.8	11.9
RX201	46.05	51.46	5.74	3.20	1.45b	11.30	0.5c	4.1	5.56	0.8	—
RX205	57.15	62.31	5.56	3.05	1.83b	11.10	0.5c	4.1	5.56	0.5	—
RX210	88.90	97.64	9.53	5.41	3.18b	19.05	0.8c	6.4	9.53	0.8	—
RX215	130.18	140.89	11.91	5.33	4.24b	25.40	1.5c	7.9	11.91	0.8	—